



PUSH TROLLEY

These Global Push Trolleys feature the highest quality manufacturing against a very competitive price. Complying to the Australian 4991 standard.



FEATURES

- All Global models are manufactured to comply with AS4991
- Fully adjustable to suit various beam widths
- Fitted with anti-drop plates for improved safety and compliance
- High-grade, fully sealed bearings for maintenance free extended life

SPECIFICATIONS

Model	GLPT050	GLPT100	GLPT200	GLPT300	GLPT500	GLPT10T
Rated Capacity (Kg)	500	1,000	2,000	3,000	5,000	10,000
Test load (Kg)	750	1,500	3,000	4,500	7,500	15,000
Beam width range (mm)	50-152	64-203	88-203	100-203	114-203	124-203
Pin configuration	Single	Single	Single	Single	Single	Double
Min. radius of curve (m)	0.8	0.9	1.0	1.2	1.3	2.0
Net weight (Kg)	6.0	11.5	18	30	44	86

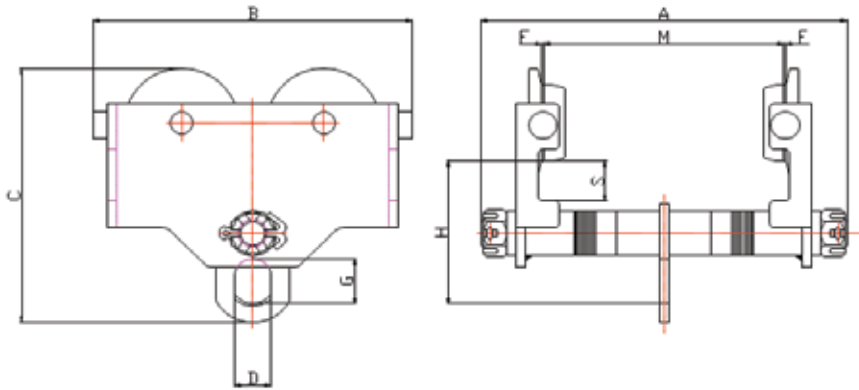

DIMENSIONS

Model	GLPT050	GLPT100	GLPT200	GLPT300	GLPT500	GLPT10T
A	244	310	327	342	354	380
B	223	270	300	356	405	490
C	188	224	261	3085	354	395
D	24	30	38	40	50	72
F	1.5 - 3.0					2-3.5
G	32	40	52	62	75	112
H	105	126.5	146	169	197	189
S	30	35.5	36	38	41	45
M (MIN./MAX.)	50 - 152	64 - 203	88 - 203	100 - 203	114 - 203	124-203